

VILLA TYPE A

NAME	INTERNAL AREA (M <sup>2</sup> )
LIVING & DINING ROOM	99.4
CLOAK 1	4.1
STORE 1	4.1
ENTRANCE TERRACE	10.5
VERANDAH	90.9
POOL TERRACE & GAZEBO	114.7
SWIMMING POOL	54.1
POOL PLANT ROOM	3.6
MASTER BEDROOM	37.2
BATHROOM 1	25.8
DRESSER 1	12
BEDROOM 2	20.4
BATHROOM 2	12.5
DRESSER 2	4.2
PORCH 2	8.3
BEDROOM 3	23.5
BATHROOM 3	12.5
DRESSER 3	4.2
PORCH 3	10.2
BEDROOM 4	27.9
BATHROOM 4	14.9
DRESSER 4	4.5
PORCH 4	10.2
KITCHEN	27.5
STORE 2	4.4
LAUNDRY	11.5
CARPORT	48.8
BOILER/GAS BOTTLES	2.2
CORRIDOR 1 & PORCH 5	17.1
CORRIDOR 2	12.6
<b>TOTAL</b>	<b>793.8 M<sup>2</sup></b>

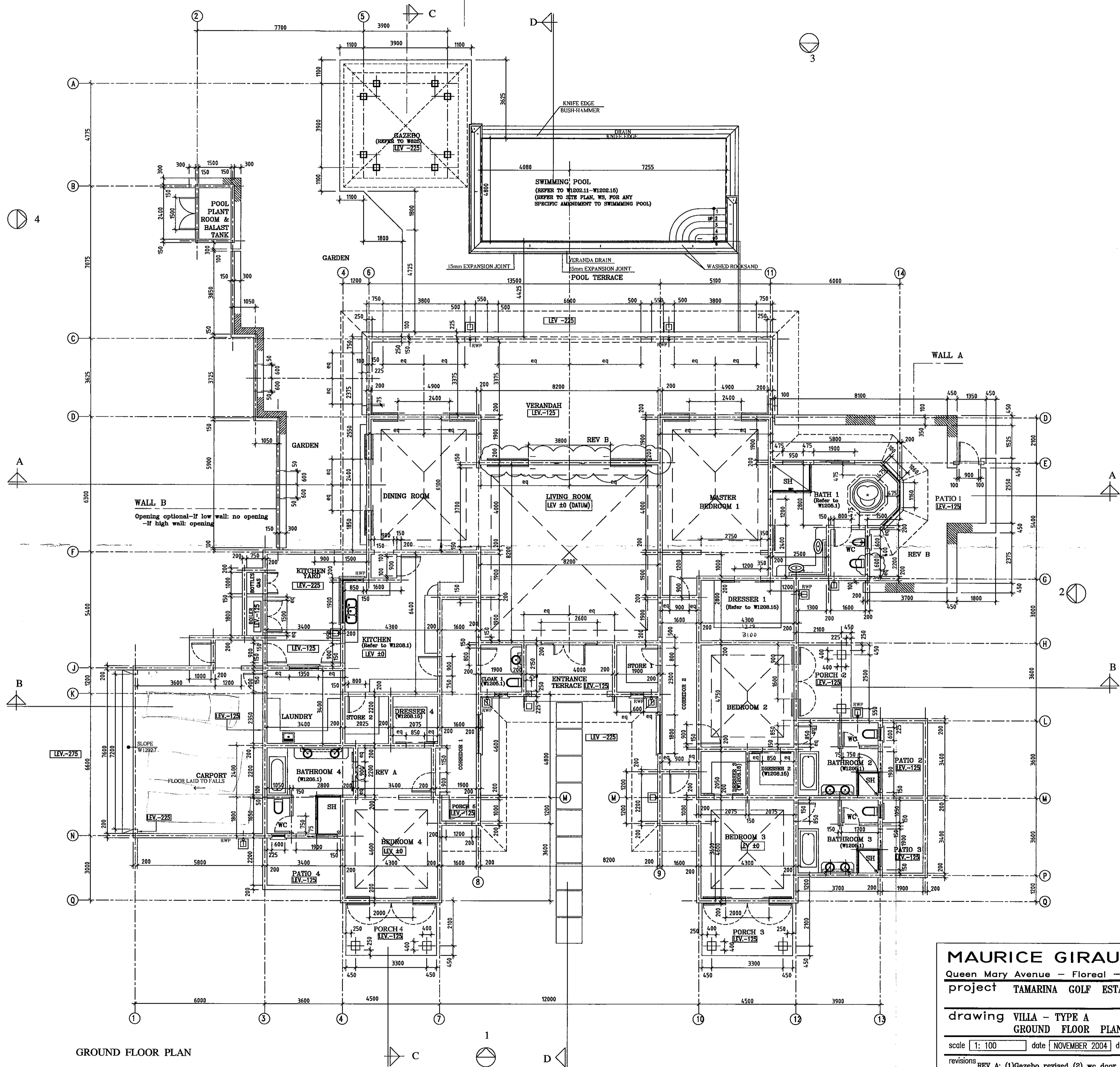

GROUND FLOOR PLAN

**ALTERNATIVE CARPORT**  
This plan applies only to specific plots & will only be used when indicated on site plan, WS.

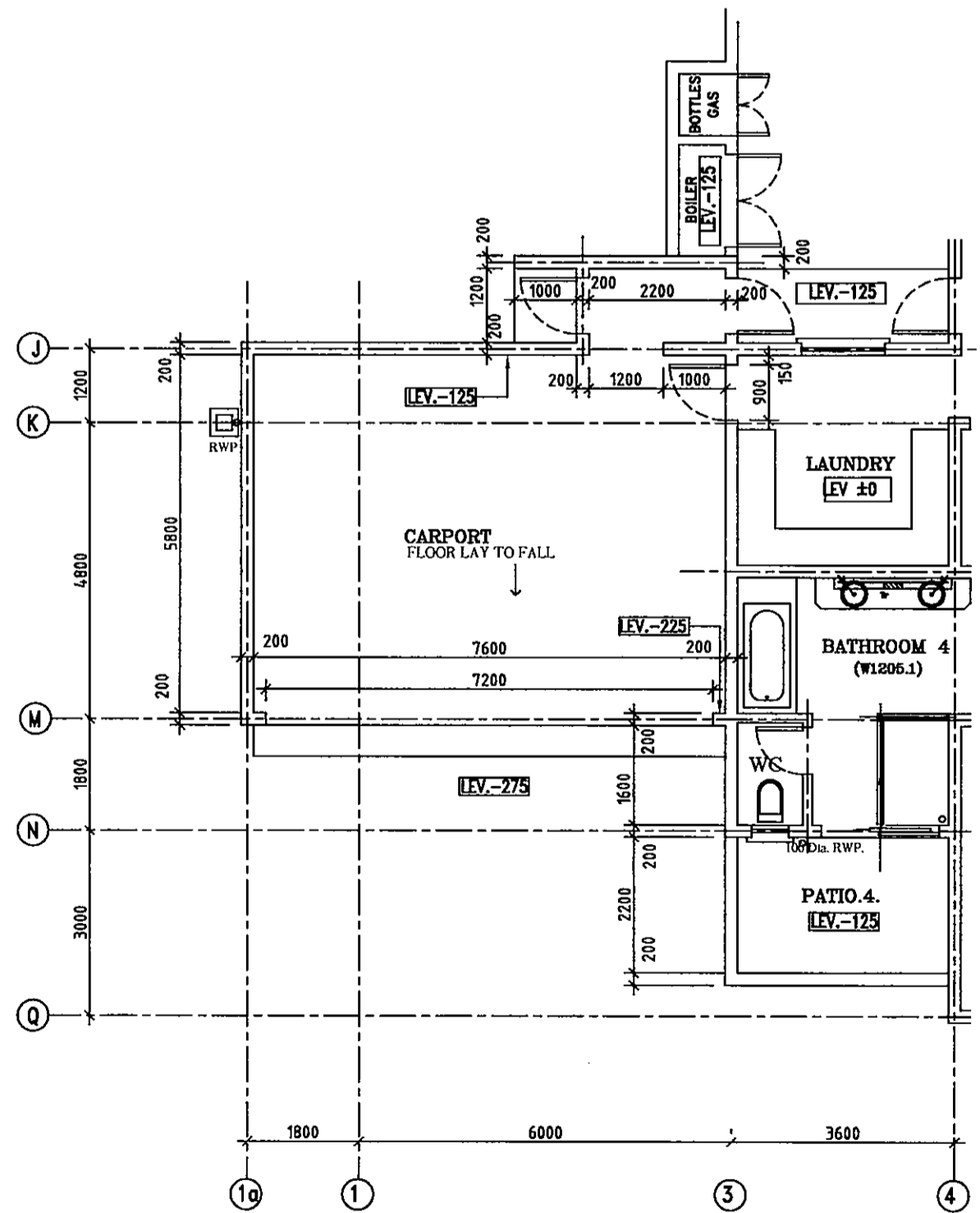

**FOR CONSTRUCTION**

**MAURICE GIRAUD ARCHITECT**  
Queen Mary Avenue - Floreal - Mauritius - Tel: 686-3494  
project TAMARINA GOLF ESTATES CO. LTD. TIRS/MSE/2004

drawing VILLA - TYPE A  
GROUND FLOOR PLAN W 100 REV. B

scale 1:100 date NOVEMBER 2004 drawn J. I. SM checked

revisions REV A: (1)Gazebo revised (2) wc door to bath 2,3,& 4 revised (3)Blockwork indicated below wash hand basin (4)Rain water pipes added (5) Columns re porch revised (6)Splay to Slab revised to 475 21/4/06 Rev REV B (1)Window AEG2 in WC to master bathroom cancelled WC move to opposite side 12/6/06 Rev(2)Amend door.AE55-25.10.06-SM

All dimensions to be checked on Site before any work is put in hand.  
Any discrepancies which may occur to be reported back to the Architect.

**NOTES:**  
-Bathrooms, Built in furniture, Openings, & Kitchen refer to detail.  
-Wall A to be adjusted & confirmed, refer to individual site plan, WS.