

SITE PLAN  
APPLICATION FOR PIN

Site Location	Quatre Bornes
District	Plaines Wilhems
Owner (land)	"Societe George Town"
Title Deed (land)	T.V. 1414 No. 116
Extent of land	3714.36m <sup>2</sup> or 0A88ps
Title Deed (Regl. Co-prop.)	T.V. 1706 No. 162
Title Deed	T.V. 1898 No. 78
Lot No.	Lot No. 27
Extent & Quote	Lot No. 27 - 33.80m <sup>2</sup> - 49/10,000emes
Part of Lot	
Land Surveyor	Binayasingh Roodun
Date	20 - July, 2016

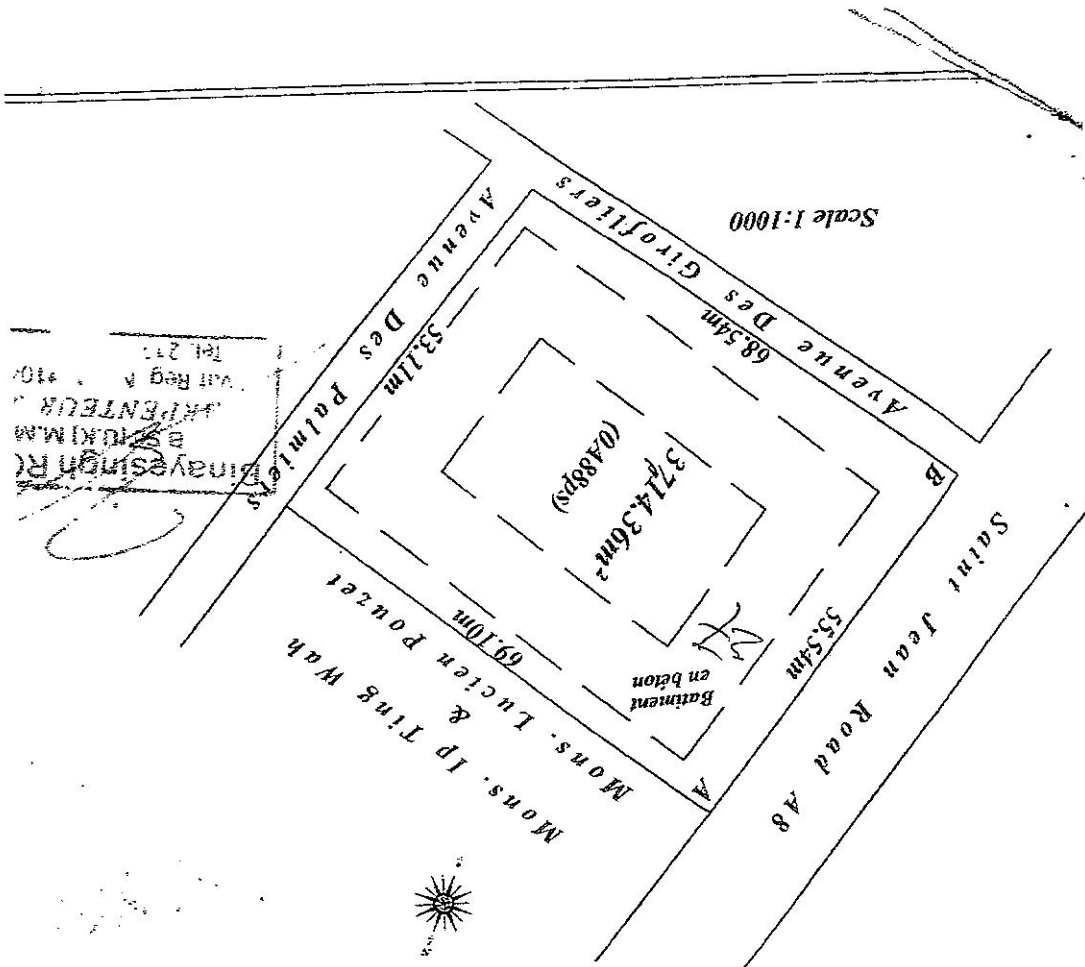

Binayasingh R  
B. BINAYASINGH  
ARCHITECTURE  
Tel. 2711  
Vall Reg. N° 4107